



Judging Schedule – Cream City Canines AKC Scent Detective Trials Saturday – Sunday, April 18-19, 2026



Saturday – Town of Norway Meyer Park Barn, 26962 Meyer Dr, Wind Lake WI
Sunday – Norway Town Hall, 6419 Heg Park Rd, Wind Lake WI

Please review your entry information in the email carefully. If any mistakes are found, please email as soon as possible. Questions? Email sue@creamcitycanines.com (preferred) or call 414-852-2681.

GENERAL INFO COVERING BOTH DAYS

Check-in/Briefing: The General Briefing will begin at 8:40am. Please do not arrive before 8:15 am CDT. You MUST arrive prior to the briefing due to line of sight issues once the trial starts. An in-person walkthrough will follow the briefing. Judging will begin promptly at 9:00 am each day.

Running Order: We will be running all of Trial 1 then all of Trial 2 both days. Armbands on Sunday were assigned to allow for those with longer travel times to run earlier in Trial 2. Running orders subject to change depending on withdrawals/wait list additions.

Wait List: There is a wait list each day, which is posted at www.creamcitycanines.com. This list will be held active up to 8:00 am on Sunday 4/19. If you are in the trial and want/need to pull, your spots will be offered to the day's wait list entrants in order. Entries withdrawn and filled by a wait list entry will have their entry fees refunded in full. All wait-listed entries that are not accepted into the trial will have their checks destroyed. If you are on the wait list and no longer want to be considered, please email the Secretary.

Warm Up: Warm up/Recovery boxes will be available. Exhibitors should limit their warm-up to one minute or less. The warm-up area is to be used exclusively for warming up the dog prior to their run, or for recovery after the run. The warm-up area is not for training or relieving of the dog.

Possession of Odors and Training: Chapter 5. Section 26 of the Scent Work Regulations state "No person other than those engaged in the administration of a trial shall be in possession of any target odor when on the trial grounds. There shall be no training on the grounds of the AKC Scent Work trial, other than the designated warm-up area."

General Site Info: Exhibitors are expected to keep the grounds at each site clean. Please pick up after your dogs. **Anyone witnessed not picking up after his/her dog will be excused from the trial weekend with no monies refunded.**

All crating is to be done in your vehicles. Dogs must be crated or secured in the cars. No ex-pens.

EMERGENCY VETERINARIAN (14.9 mi) – VCA Milwaukee Emergency Center for Animals, 3670 S 108th St, Greenfield WI
414-543-7387

CLOSEST HOSPITAL (11.5 mi) – Aurora Medical Center Burlington, 252 McHenry St, Burlington WI

HOTELS: Competitors must contact motels directly and identify themselves as having dogs. PLEASE be a responsible motel guest.

Quality Inn Sturtevant

901 S. Sylvania Ave (I-94 & Hwy 20), Sturtevant WI 53177 262-886-0385; www.choicehotels.com

La Quinta Inn Pleasant Prairie

7540 118th Ave (I-94 & Hwy 50), Pleasant Prairie WI 53158 262-857-7911; www.lq.com

Red Roof inn Milwaukee Airport

6360 S. 13th St, Oak Creek WI 53154 937-328-1419; www.redroof.com

Possible SWD Title?

If you are potentially able to earn your Scent Detective (SWD) title during the weekend, please reply to your confirmation email so we will have enough bling for you!

SATURDAY TRIALS

Site Info: This site is at a public park. There are baseball fields in the vicinity and there MAY be some games being played. The searches will be in the lower level of the Meyer Park Barn and the adjacent outdoor areas.

All crating to be done in your vehicles. Dogs must be crated or secured in the cars. No ex-pens.

Exercise area is grass near the parking lot. It is **IMPERATIVE** that you clean up after your dogs and are under your best behavior as there will be other people enjoying the park besides us.

The concession building with restrooms is right next to the Barn. Use of those restrooms will be limited during the searches.

Parking: All entrants will park in the lot as noted on the map. Part of that lot will be blocked off due to sight line issues. Day parking for RVs is available but limited, please reply if you wish to bring an RV on Saturday.

Spectators: Spectators will be limited to the outdoor search areas due to the close quarters in the indoor search area.

Food: There is a concession building next to the search area that **may** be operational that day, but to be sure please plan on bringing your lunch or going to the fast food restaurants that are ~3 miles from the site.

RUNNING ORDER

Saturday Trial 1: 1-12, 14-19, 21-27

Saturday Trial 2: 14-15, 4, 16-27, 1-3, 5-7, 9-11

Trial 1 judging begins 9:00 am each day

**Trial 2 judging begins after a lunch break
but not before 12 Noon**

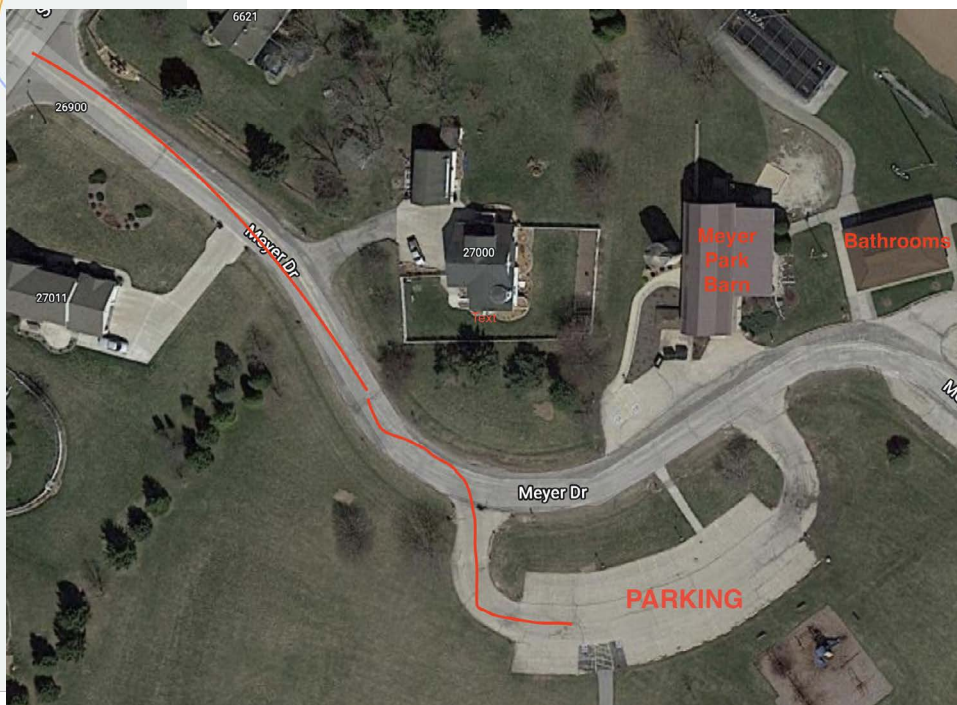
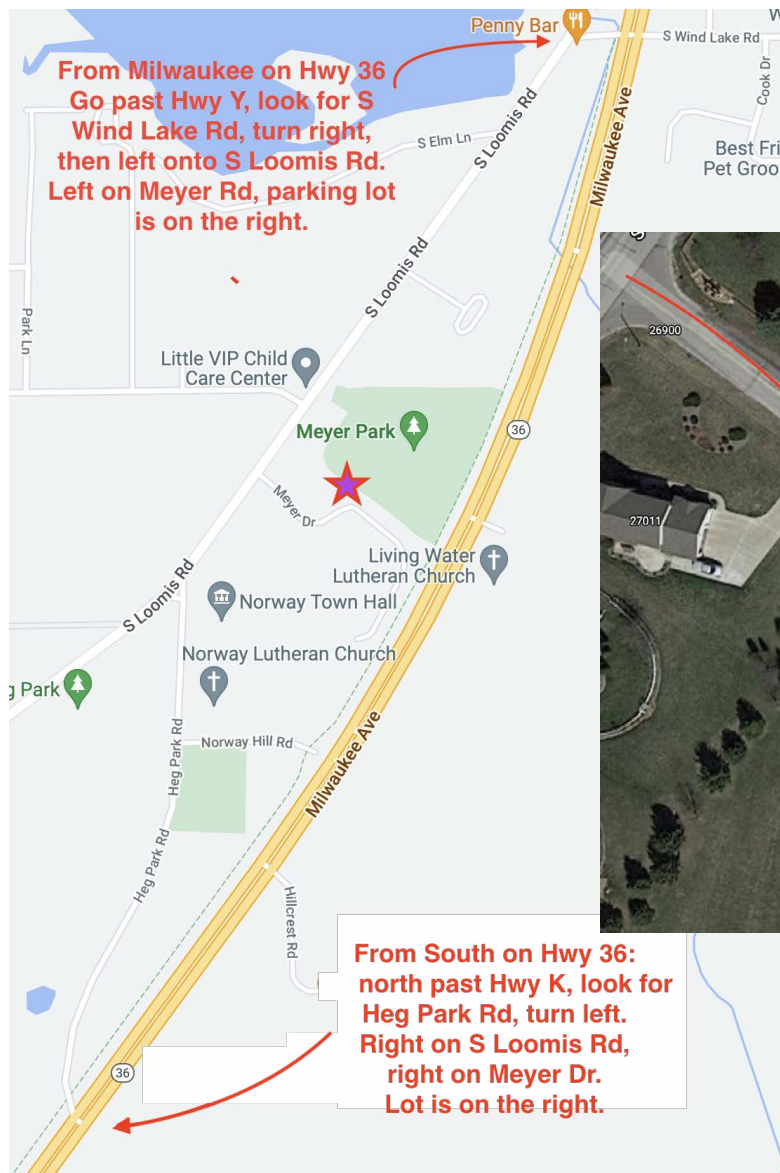

SUNDAY TRIALS

Site Info: The Town Hall is a bi-level building, with entrance doors on each level. One of the trials will be on the rear parking lot level, and the other will be on the street level of the building. Parking for both trials will be in the lot in the front of the building. Restrooms inside the front door of the Town Hall will be available all day, with some limitations during Trial 2.

Dog exercise area is grass between the parking lot and the road. DO NOT use the adjacent church building grounds to the east. All crating is to be done in your vehicles. Dogs must be crated or secured in the cars. No ex-pens.

Parking: All entrants will park in the lot as noted on the map. The spaces at the south edge (bottom of the map) will not be used. Day parking for RVs is available but limited, please reply if you wish to bring an RV on Sunday.

Spectators: Spectators will be allowed for all searches, at the discretion of the judge.

Food: No food will be available for entrants. Please plan on bringing your lunch or going to the fast food restaurants that are ~3 miles from the site.

RUNNING ORDER

Sunday Trial 1: 1-15, 17-26

Sunday Trial 2: 13-14, 3, 15-26, 1-2, 4-7, 9-12

Trial 1 judging begins 9:00 am each day
Trial 2 judging begins after a lunch break
but not before 12 Noon

